

Option 1: Single Zone WiFi (RF) Control

Components

- NevoSL with WiFi enabled
- Wireless Access Point/Router
- NevoLink with IR emitters

Benefits

- Great solution for wireless RF control
- Does not use the home LAN
- Simply uses the NevoSL and NevoLink to provide wireless (RF) control of IR devices via WiFi

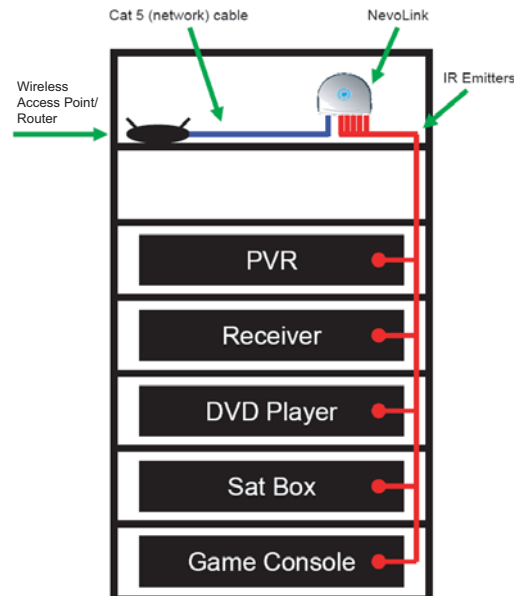

Recommended Wireless Access Point/Router Settings

• Version	Make sure latest firmware version is installed
• Router	Use an 802.11b router or set your 802.11g router to "Mixed" mode
• SSID	Set to "broadcast"
• Encryption	Set to "WPA-PSK" for best Security or "WEP" for most installations
• Noise / Channel Selection	DO NOT set to "auto" or default
• Density	Set to "High"
• Preamble	Set to "short" for normal environment or "long" for noisy environment
• Frame / ACK burst	Set to "disable"
• MAC filtering	Set to "off" or ensure Nevo MAC addresses are trusted or added
• UPNP	Set to "enabled"
• DTIM	Set to "1"
• WMM / 802.11e / QOS	Set to "disabled"
• CTS / RTS	Set to "enabled" or "auto"
• TX Rate	Set to "auto"
• TX Power	Set to highest possible setting
• Special Features	Such as turbo, etc – set to "disabled"
• RTS Threshold	Set to "default"

Based on the make and model of your wireless router, some of these setting may have different names or not appear at all. For more information, please review NevoSL 1.2 and Networking, available as a free download on www.mynevo.com.

Noisy environments are created when multiple RF devices exist in the same space. Devices that may cause WiFi interference include 2.4GHz telephones, 2.4GHz RF cameras, other WiFi networks (such as neighbors)

Recommended NevoSL Wireless Settings

- Make sure the latest software version has been installed
- Encryption, Density, and Preamble information must match router settings exactly (these are set using the on-device Advanced Settings screen - see page 28 of NevoSL 1.2 and Networking)

Option 2: Multi-Zone WiFi (RF) Control and Digital Media Streaming

Components

- NevoSL with WiFi enabled
- Wireless router in different location
- Windows® XP PC with media content
- HomePlug® adapter or WiFi Bridge
- NevoLink with IR emitters
- Compatible wireless media player such as: D-Link® Media Lounge, Roku Soundbridge, and others. See complete list at www.mynevo.com.

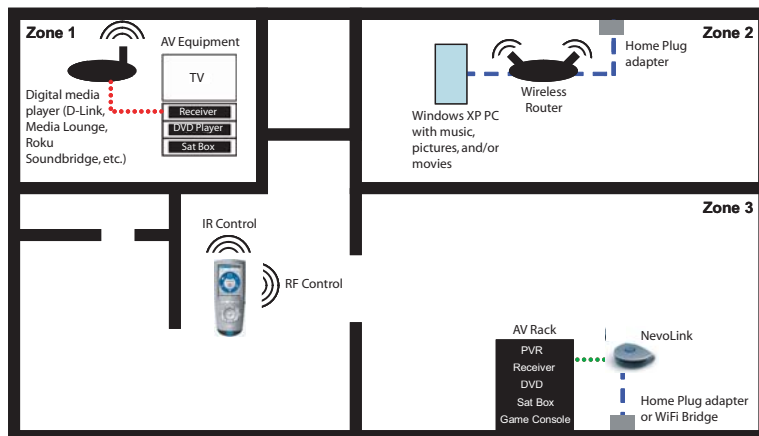

..... A/V Cable
--- Cat 5 Cable
..... IR Emitters

Benefits

- Does not require running network (cat 5) cables throughout the home
- Ethernet access in the Home Theater can be provided through existing AC lines using HomePlug adapters or WiFi Bridge
- Provides control of media content located on a Windows XP PC streamed to any zone

Considerations

- Both wireless devices (router and media player) use shared air space (having 2 does not increase throughput)
- Must consider AC phase when using HomePlug

General WiFi and NevoSL System Setup Notes

- NevoSL uses 802.11b protocol which transmits at 2.4GHz
- There are other devices, such as phone systems, that operate on this frequency and may introduce interference
- Place your wireless access points in elevated locations (such as on a shelf, at the top of a rack, or the second floor) to achieve the best performance
- NevoSL can be used to identify and optimize to prevent interference (see page 59 of NevoSL 1.2 and Networking, available for free download in the dealer section of mynevo.com)

Recommended NevoSL Wireless Settings

- Make sure the latest software version has been installed
- Encryption, Density, and Preamble information must match router settings exactly (these are set using the on-device Advanced Settings screen - see page 28 of NevoSL 1.2 and Networking)

Recommended MediaManager Settings

- Firewall or anti-virus software must be set to trust all Nevo programs or be turned off
- Enable UPnP service in the firewall

All trademarks used are the property of their respective owners.